

Technical Partition Wall System



 is a special system of partition walls, completely designed and manufactured by **MOMOLINE**[®] and specifically conceived and engineered for laboratory environments.

 technical wall systems is completely modular, so that it can be easily installed in every location, with no necessity of modifications or adjustments on site.

The panels can be equipped with glazed windows (either in safety glass or in polymer according to the specific application) and with doors in the desired locations.

Windows are available in different sizes.

All modular panels are already fitted with dedicated technical compartments for the passage of lines and systems, and all the services (electric, fluids, data) can be installed on the wall.

 technical wall system is suitable for installation in clean rooms, since it is easy to clean and disinfect, and the panels can be sealed to grant efficient leak-proof containment, with complete absence of any groove. This is essential for highly clean applications (Pharmaceutical, Microbiology, Electronics, ...).

Main features of Technical Partition System:

- Modular panels, pre-assembled in factory
- No modification or adjustments on site, simple assemblage
- Internal structure realized in zinc-coated steel sheets, bended and joined (crimped) with cold processes to prevent oxidation
- External covering available in different materials:
 - HPL (High Pressure Laminate)
 - CORIAN
 - Stainless Steel (AISI 304 or AISI 316)
- Possibility of installing panels with completely seamless joints, to eliminate any groove (possible receptacles for bacteria/germs/dust/soil). This is particularly recommended in clean rooms applications.
- Possibility of installation of services on panels (Electric sockets, fluids taps, pressure reducers, ...)



- Possibility of pre-arranged technical compartments to allow the passage of pipes/cables/systems. The technical compartments can be easily opened for inspection and maintenance, with no tools.

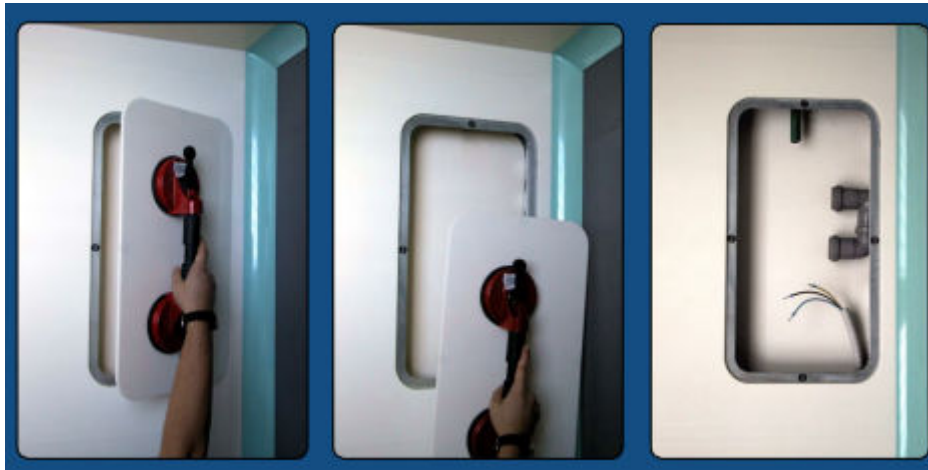

- Possibility of easily de-assemble the structure in case of needs, in order to change the layout configuration, and to allow the entrance of big equipments.
- Installation of molded shell with circular profile between wall and floor/ceiling, to avoid grooves and receptacles.

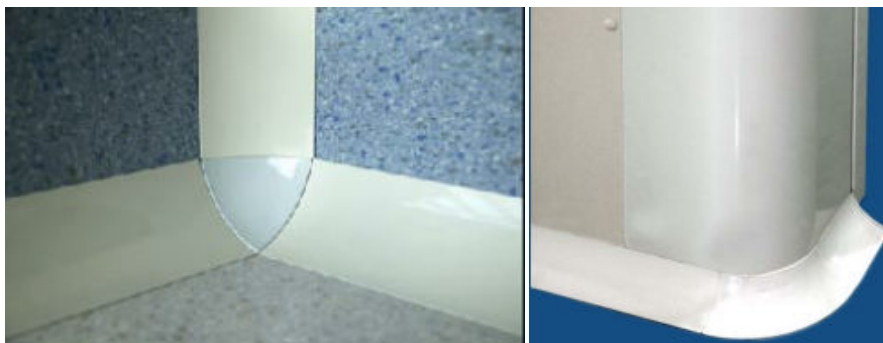

- Possibility of creating a completely insulated "analytical cell" (technical walls, joined together to floor and ceiling) completely separated from the external environment, to obtain enhanced cleanliness and insulation performances.

Examples of Installation



